

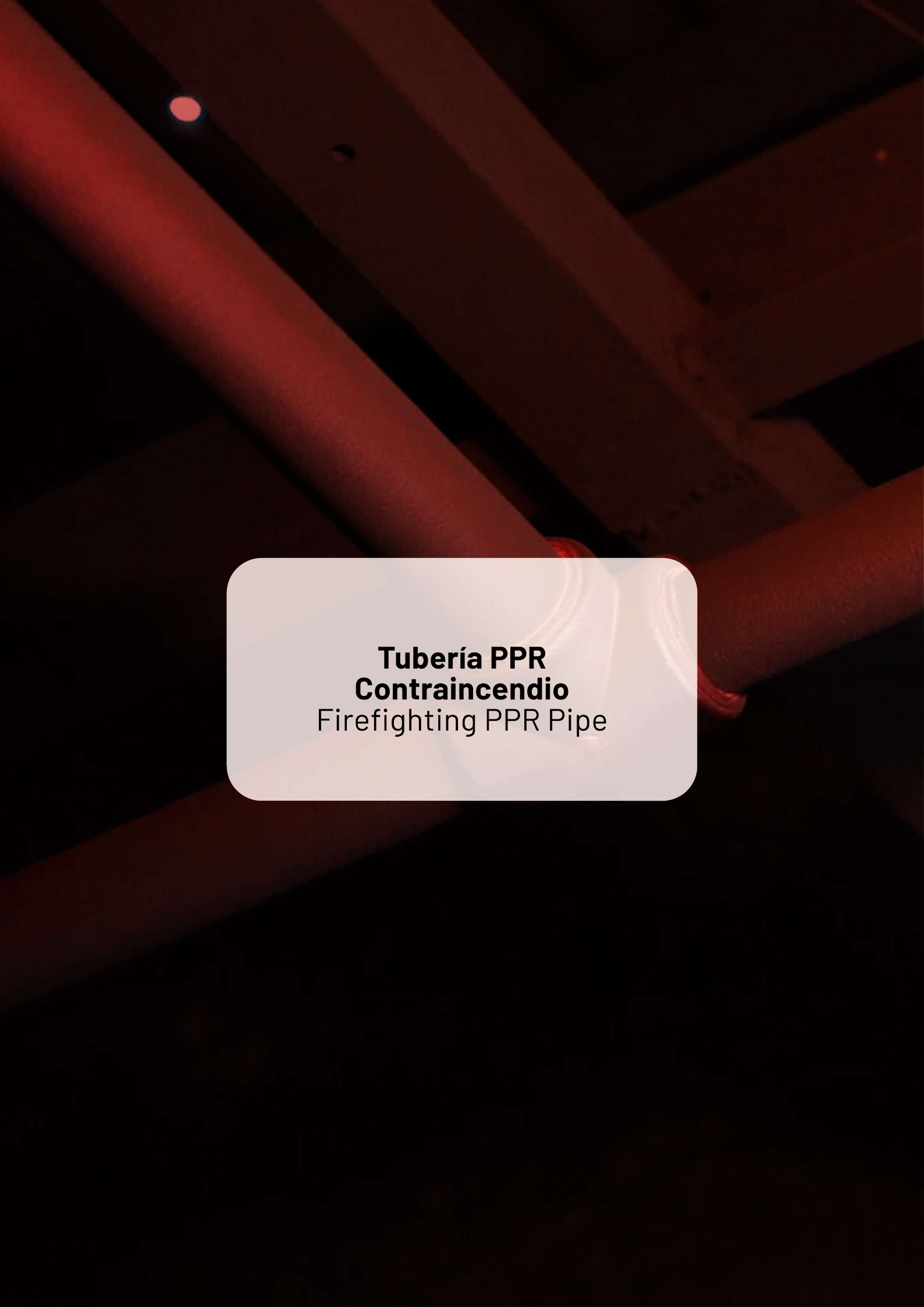



Sistema FIRE

FIRE System



Tubería PPR
Contraincendio
Firefighting PPR Pipe



REPOLEN FASER FIRE RP

SERIE 3,2 SDR7,4 PN16
 SERIE 5 SDR 11 PN10



Estructura MCF (MULTICAPA FV, FASER)
Material PP-RCT FIRE REPOLEN
Normativa UNE EN 15874; UNE EN ISO 21003; DIN 8077; UNE 23500; UNE EN 671; UNE EN 12845; CTE; RIPCI; RSCIEI
Color INTERIOR VERDE RAL 6024 EXT. ROJO RAL 3028
Suministro BARRAS 4M / EMBOLSADO

Structure MCF (MULTILAYER GF, FASER)
Material PP-RCT FIRE REPOLEN
Regulations UNE EN 15874; UNE EN ISO 21003; DIN 8077; UNE 23500; UNE EN 671; UNE EN 12845; CTE; RIPCI; RSCIEI
Colour INNER GREEN RAL 6024 OUTER RED RAL 3028
Supply 4M LENGTH / BAGGED

Structure MCF (MULTICOUCHE FV, FASER)
Matériel PP-RCT FIRE REPSOL
Norme UNE EN 15874; UNE EN ISO 21003; DIN 8077; UNE 23500; UNE EN 671; UNE EN 12845; CTE; RIPCI; RSCIEI
Couleur INTÉRIEUR VERT RAL 6024 EXT. ROUGE RAL 3028
Fourniture BARRES 4 M / ENSACHÉ

S - SDR	código	d	di	e	capacidad (L/m)	m/paquetes	peso (kg/m)	paquetes palet	€/m
	code	(mm)	(mm)	(mm)	capacity (L/m)	m/bags	weight (kg/m)	packs palet	
3,2 - 7,4	431500006	25	20,4	3,5	0,254	80	0,260	28	4,867
	430500005	32	26,2	2,9	0,539	60	0,297	23	6,443
5 - SDR 11	430500004	40	32,6	3,7	0,835	40	0,463	23	9,977
	430500009	50	40,8	4,6	1,307	20	0,718	28	14,656
	430500010	63	51,4	5,8	2,075	12	1,093	30	22,641
	430500011	75	61,4	6,8	2,961	12	1,553	23	30,877
	430500012	90	73,6	8,2	4,254	8	2,262	20	44,183
	430500013	110	90	10	6,362	4	3,360	27	59,985
	430500014	125	102,2	11,4	8,203	4	4,301	20	82,947
	430500016	160	130,8	14,6	13,437	4	6,821	12	122,954



**Accesorios PPR
contra incendios**
Firefighting PPR Fittings

CODO 90°HEMBRA/HEMBRA
90° FEMALE/FEMALE ELBOW
COUDE 90° FEMELLE/FEMELLE

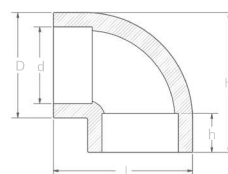

code	Ø (mm)	d (mm)	D (mm)	h (mm)	H (mm)	L (mm)				€/U
822R02525	25	25	34,5	16,0	44,5	46,0	10	100	2.670	0,860
822R03232	32	32	42,3	18,4	59,9	55,6	10	50	2.150	1,435
822R04040	40	40	54,9	21,6	71,3	71,5	6	24	2.380	2,669
822R05050	50	50	68,5	23,5	83,0	83,0	4	12	1.990	5,698
822R06363	63	63	84,5	27,5	101,0	100,0	2	6	1.885	9,112
822R07575	75	75	99,5	30,0	119,5	119,0	1	3	1.550	15,400
822R09090	90	90	120,4	35,9	142,2	142,6	1	3	2.970	29,622
822R00110	110	110	146,5	37,0	172,0	176,5	1	4	7.055	49,688
822R00125	125	125	162,0	40,0	181,0	181,0	1	2	3.930	74,449

CODO 45°HEMBRA/HEMBRA
45° FEMALE/FEMALE ELBOW
COUDE 45° FEMELLE/FEMELLE

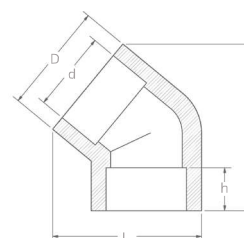

code	Ø (mm)	d (mm)	D (mm)	h (mm)	H (mm)	L (mm)				€/U
823R02525	25	25	36,0	16,0	60,0	50,0	10	80	2.305	1,079
823R03232	32	32	45,0	18,0	72,0	60,0	10	40	2.255	1,515
823R04040	40	40	55,5	20,5	83,0	71,0	6	24	2.360	3,058
823R05050	50	50	65,5	23,5	89,5	79,0	3	15	1.965	5,125
823R06363	63	63	84,0	27,5	97,0	96,5	2	8	2.050	9,164
823R07575	75	75	98,5	30,0	114,5	115,0	1	4	1.610	13,462
823R09090	90	90	121,5	33,0	133,0	139,0	1	3	2.115	31,774
823R00110	110	110	150,0	37,0	167,5	173,0	1	4	5.020	48,872
823R00125	125	125	162,0	40,0	184,5	188,0	1	4	4.600	71,337

MANGUITO
COUPLER
MANCHON

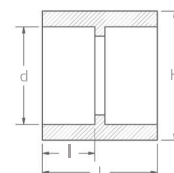

code	Ø (mm)	d (mm)	H (mm)	l (mm)	L (mm)				€/U
821R02525	25	25	33,0	16,0	37,0	10	100	1.670	0,797
821R03232	32	32	43,5	18,0	42,5	10	70	2.410	1,122
821R04040	40	40	52,0	20,5	46,0	6	42	2.100	1,972
821R05050	50	50	68,5	23,5	55,5	3	18	2.100	3,726
821R06363	63	63	83,5	27,5	61,5	3	15	2.460	5,886
821R07575	75	75	99,0	30,0	66,5	2	10	2.560	8,998
821R09090	90	90	119,0	33,0	74,0	2	6	2.490	17,982
821R00110	110	110	154,5	37,0	88,0	1	4	3.565	29,987
821R00125	125	125	163,0	40,0	90,0	1	6	4.780	38,986

REDUCCIÓN MACHO/HEMBRA
MALE/FEMALE REDUCER PIPE
RÉDUCTION MÂLE/FEMELLE

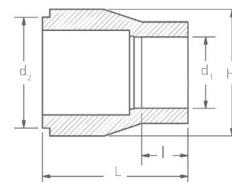

code	Ø (mm)	d2 (mm)	d1 (mm)	H (mm)	l (mm)	L (mm)				€/U
820R13225	32 x 25	32	25	33,0	16,0	45,0	10	100	2.050	0,903
820R14025	40 x 25	40	25	41,0	16,0	49,0	6	60	2.195	1,777
820R14032	40 x 32	40	32	43,0	18,0	49,0	6	60	2.375	2,053
820R15025	50 x 25	50	25	50,0	16,0	53,0	3	36	1.810	3,413
820R15032	50 x 32	50	32	50,5	18,0	53,5	3	36	2.015	3,413
820R15040	50 x 40	50	40	52,0	20,5	56,0	3	30	2.085	3,413
820R16325	63 x 25	63	25	63,5	16,0	63,5	3	30	2.771	4,979
820R16332	63 x 32	63	32	63,5	18,0	63,5	3	30	2.690	4,979
820R16340	63 x 40	63	40	63,5	20,5	64,0	3	24	2.390	6,815
820R16350	63 x 50	63	50	68,5	23,5	63,5	3	15	1.875	7,078
820R17532	75 x 32	75	32	75,5	18,0	66,5	2	20	2.655	6,699
820R17540	75 x 40	75	40	76,0	20,5	67,0	2	20	2.790	8,156
820R17550	75 x 50	75	50	75,5	23,5	66,5	2	16	2.480	8,156
820R17563	75 x 63	75	63	84,5	27,5	69,5	2	16	3.090	8,336
820R19063	90 x 63	90	63	90,0	27,5	76,0	2	8	2.090	15,906
820R19075	90 x 75	90	75	99,5	30,0	79,5	1	8	2.550	16,55
820R11063	110 x 63	110	63	110,0	27,5	84,0	1	6	2.295	17,075
820R11075	110 x 75	110	75	110,5	30,0	89,0	1	3	1.365	17,075
820R11090	110 x 90	110	90	118,5	33,0	98,5	1	3	1.755	22,225

REDUCCIÓN HEMBRA/HEMBRA
FEMALE/FEMALE REDUCER PIPE
RÉDUCTION FEMELLE/FEMELLE

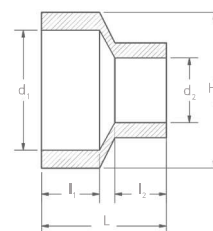

code	Ø (mm)	d1 (mm)	d2 (mm)	H (mm)	l1 (mm)	l2 (mm)	L (mm)				€/U
820R03225	32 x 25	32	25	41,5	18,0	16,0	42,0	10	90	2.240	1,916
820R04032	40 x 32	40	32	51,0	20,5	18,0	45,0	6	60	2.411	1,998
820R05040	50 x 40	50	40	68,5	23,5	20,5	59,5	3	15	1.915	4,933
820R06350	63 x 50	63	50	83,0	27,5	23,5	61,0	3	15	2.910	7,662
820R07563	75 x 63	75	63	99,0	30,0	27,5	66,0	2	8	2.554	13,084
820R09075	90 x 75	90	75	119,5	33,0	30,0	72,0	2	6	2.943	21,514

TE LISA HEMBRA
FEMALE TEE
TÉ SIMPLE

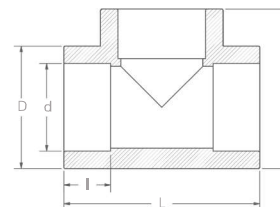

code	Ø (mm)	d (mm)	D (mm)	H (mm)	l (mm)	L (mm)				€/U
824R02525	25	25	35,0	48,0	16,0	61,0	10	60	2.470	1,066
824R03232	32	32	45,0	58,5	18,0	74,5	5	30	2.245	1,929
824R04040	40	40	55,0	70,0	20,5	86,0	6	18	2.360	3,059
824R05050	50	50	69,5	84,0	23,5	98,0	2	12	2.640	6,956
824R06363	63	63	83,5	101,5	27,5	115,0	1	6	2.130	12,359
824R07575	75	75	98,0	116,5	30,0	138,5	1	3	1.715	15,509
824R09090	90	90	123,0	138,5	33,0	157,5	1	3	3.260	35,643
824R00110	110	110	145,0	166,5	37,0	192,5	1	4	6.785	58,950
824R00125	125	125	164,5	182,0	40,0	208,0	1	2	4.815	81,568



TE REDUCIDA HEMBRA

FEMALE REDUCER TEE

TÉ RÉDUCTION

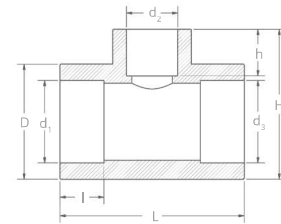

code	Ø (mm)	d1 (mm)	d2 (mm)	d3 (mm)	D (mm)	h (mm)	H (mm)	I (mm)	L (mm)			GR BOX	€/U
825R22532	32 x 25 x 32	32	25	32	43,0	16,0	58,5	18,0	74,5	5	30	2.210	2,951
825R02540	40 x 25 x 40	40	25	40	55,0	16,0	73,0	20,5	86,5	6	18	2.285	3,578
825R03240	40 x 32 x 40	40	32	40	55,0	18,0	70,5	20,5	86,0	6	18	2.565	3,578
825R02550	50 x 25 x 50	50	25	50	65,5	16,0	76,5	23,5	95,5	2	12	2.160	7,297
825R03250	50 x 32 x 50	50	32	50	66,0	18,0	76,0	23,5	96,0	2	12	2.075	7,297
825R04050	50 x 40 x 50	50	40	50	68,5	20,5	85,0	23,5	98,5	2	12	2.855	8,097
825R32563	63 x 25 x 63	63	25	63	82,5	16,0	87,5	27,5	115,5	2	8	2.540	12,238
825R33263	63 x 32 x 63	63	32	63	82,5	18,0	92,5	27,5	115,5	2	8	2.525	12,238
825R34063	63 x 40 x 63	63	40	63	83,0	20,5	92,5	27,5	115,0	2	8	2.525	12,238
825R35063	63 x 50 x 63	63	50	63	83,0	23,5	95,5	27,5	115,0	2	8	2.315	12,719
825R53275	75 x 32 x 75	75	32	75	98,5	18,0	106,0	30,0	127,0	1	4	2.250	20,397
825R54075	75 x 40 x 75	75	40	75	100,0	20,5	108,5	30,0	126,0	1	4	2.200	20,397
825R55075	75 x 50 x 75	75	50	75	99,0	23,5	109,0	30,0	126,5	1	4	2.210	20,397
825R56375	75 x 63 x 75	75	63	75	98,5	27,5	116,0	30,0	137,5	1	3	1.905	22,393
825R05090	90 x 50 x 90	90	50	90	122,0	23,5	133,5	33,0	157,5	1	3	3.325	36,718
825R06390	90 x 63 x 90	90	63	90	121,0	27,5	134,0	33,0	157,5	1	3	3.175	36,718
825R07590	90 x 75 x 90	90	75	90	122,0	30,0	138,5	33,0	157,5	1	3	3.450	36,718
825R11063	110 x 63 x 110	110	63	110	147,0	27,5	149,5	37,0	175,0	1	2	2.850	58,034
825R11075	110 x 75 x 110	110	75	110	147,5	30,0	163,0	37,0	177,5	1	2	3.230	58,034
825R11090	110 x 90 x 110	110	90	110	148,5	33,0	164,0	37,0	177,5	1	2	3.030	58,034

CRUZ REDUCIDA HEMBRA

FEMALE REDUCING CROSS

CROIX RÉDUITE FEMELLE

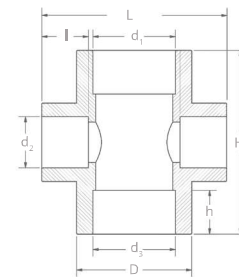

code ¹	Ø (mm)	d1 (mm)	d2 (mm)	d3 (mm)	D (mm)	h (mm)	H (mm)	I (mm)	L (mm)			GR BOX	€/U
853R15032	50 x 32 x 50	50	32	50	66,0	23,5	-	18,0	96,0	2	8	2.122	18,895
853R16332	63 x 32 x 63	63	32	63	82,5	27,5	-	18,0	115,5	1	6	2.050	21,755
853R16340	63 x 40 x 63	63	40	63	83,0	27,5	92,5	20,5	115,0	1	6	2.036	21,982
853R17532	75 x 32 x 75	75	32	75	98,5	30,0	106,0	18,0	127,0	1	4	2.362	28,998
853R17540	75 x 40 x 75	75	40	75	100,0	30,0	108,5	20,5	126,0	1	3	2.381	29,863
853R17550	75 x 50 x 75	75	50	75	99,0	30,0	109,0	23,5	126,5	1	3	1.791	34,972
853R19050	90 x 50 x 90	90	50	90	122,0	33,0	133,5	23,5	157,5	1	3	3.494	46,994

(1) Accesorio manipulado garantía y compatibilidad con todos los accesorios del sistema REPOLEN FIRE RP / (1) Handled fitting, guaranteed and compatible with all accessories of the REPOLEN FIRE RP system / (1) Accessoire manipulé, garanti et compatible avec tous les accessoires du système REPOLEN FIRE RP

TAPÓN
END CAP
BOUCHON

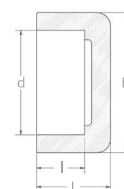

	code	Ø (mm)	d (mm)	H (mm)	l (mm)	L (mm)				€/U
SOLDADURA SOCKET	826R02525	25	25	32,0	16,0	30,5	10	150	2.330	0,939
	826R03232	32	32	44,5	18,0	32,0	10	80	2.515	1,761
	826R04040	40	40	52,0	20,5	30,0	6	60	2.415	2,376
	826R05050	50	50	65,0	23,5	34,0	3	36	2.510	4,812
	826R06363	63	63	82,0	27,5	43,0	3	21	2.915	6,109
	826R07575	75	75	98,0	30,0	52,0	2	12	2.805	10,245
	826R09090	90	90	119,0	33,0	65,0	1	7	3.240	20,983
	826R00110	110	110	144,5	37,0	63,5	1	5	3.050	29,555
	826R25160	125	125	160,0	40,0	65,0	1	4	3.435	43,250

(1) Tapón válido para soldar a socket en Ø125mm y para soldar a tope en Ø160 mm / (1) End cap suitable for socket fusion welding in Ø125mm and for butt fusion welding in Ø160mm / (1) Bouchon adapté au soudage par emboîtement en Ø125mm et au soudage bout à bout en Ø160mm

CODO 90° ROSCA HEMBRA
90° THREADED FEMALE ELBOW
COUDE 90° FILETAGE FEMELLE

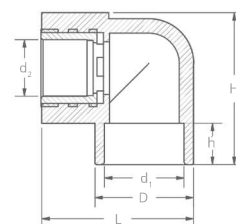

	code	Ø (mm)	d1 (mm)	d2 (pulg / in)	D (mm)	h (mm)	H (mm)	L (mm)				€/U
	830R22520	25 x 1/2"	25	1/2"	36,0	16	56,0	55,5	10	60	4.520	5,998
	830R22525	25 x 3/4"	25	3/4"	35,5	16	53,5	64,5	5	50	4.720	7,253
	830R23225	32 x 3/4"	32	3/4"	45,5	18	62,5	63,0	5	40	4.385	7,992
	830R23232	32 x 1"	32	1"	44,0	18	66,5	79,5	5	20	5.430	15,143

TE ROSCA HEMBRA
THREADED FEMALE TEE
TÉ FILETAGE FEMELLE



	code	Ø (mm)	d1 (mm)	d2 (pulg / in)	D (mm)	H (mm)	l (mm)	L (mm)				€/U
	829R22520	25 x 1/2" x 25	25	1/2"	35,5	53,5	16,0	67,5	10	50	4.200	6,373
	829R22525	25 x 3/4" x 25	25	3/4"	35,0	56,5	16,0	63,0	10	40	3.875	7,817
	829R23225	32 x 3/4" x 32	32	3/4"	42,5	67,5	18,0	74,5	5	25	3.205	8,733
	829R24020	40 x 1/2" x 40	40	1/2"	55,0	73,0	21,0	86,0	5	20	3.230	10,576
	829R23232	32 x 1" x 32	32	1"	45,0	77,5	18,0	74,5	4	20	3.562	15,846
	829R25025	50 x 3/4" x 50	50	3/4"	65,5	75,5	23,5	95,5	2	12	2.784	15,474
	829R26325	63 x 3/4" x 63	63	3/4"	82,0	102,0	27,5	115,0	2	6	2.482	24,842

MANGUITO ROSCA HEMBRA
THREADED FEMALE COUPLER
MANCHON FILETAGE FEMELLE

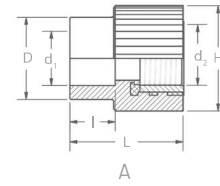

code	type	∅ (mm)	d1 (mm)	d2 (pulg / in)	D (mm)	H (mm)	I (mm)	L (mm)				€/U
827R22520	A	25 x 1/2"	25	1/2"	34,5	40,0	16	42,0	10	90	5.770	4,941
827R22525	A	25 x 3/4"	25	3/4"	34,5	44,5	16	40,5	10	80	5.730	5,577

MANGUITO ROSCA HEMBRA
THREADED FEMALE COUPLER
MANCHON FILETAGE FEMELLE

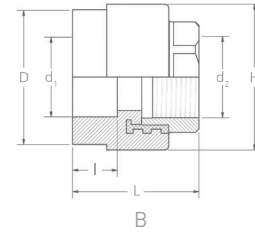

code	type	∅ (mm)	d1 (mm)	d2 (pulg / in)	D (mm)	H (mm)	I (mm)	L (mm)				€/U
827R23220	B	32 x 1/2"	32	1/2"	46,0	51,5	18	44,5	5	50	4.250	7,127
827R23225	B	32 x 3/4"	32	3/4"	46,0	51,5	18,0	44,5	5	50	4.480	8,123
827R23232	B	32 x 1"	32	1"	47,5	60,5	18,0	60,5	5	30	7.120	15,892
827R24032	B	40 x 1"	40	1"	64,5	71,0	20,5	56,5	3	24	6.535	19,053
827R24040	B	40 x 1-1/4"	40	1-1/4"	65,0	75,0	20,5	61,5	3	18	5.925	28,098
827R24020	B	40 x 1/2"	-	-	-	-	-	-	5	40	4.110	32,899

MANGUITO ROSCA HEMBRA
THREADED FEMALE COUPLER
MANCHON FILETAGE FEMELLE

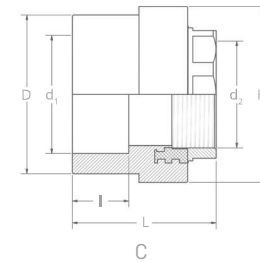

code	type	∅ (mm)	d1 (mm)	d2 (pulg / in)	D (mm)	H (mm)	I (mm)	L (mm)				€/U
827R25050	C	50 x 1-1/2"	50	1-1/2"	68,0	80,5	23,5	66,5	3	15	6.215	32,899
827R26363	C	63 x 2"	63	2"	83,5	92,5	27,5	77,5	2	8	4.165	41,394
827R27575	C	75 x 2-1/2"	75	2-1/2"	98,0	119,5	30,0	79,5	1	6	5.290	73,449
827R29090	C	90 x 3"	90	3"	119,0	143,0	33,0	102,5	1	3	5.165	134,477
827R20110	C	110 x 4"	110	4"	154,0	157,5	37,0	119,0	1	3	6.270	151,205

MANGUITO ROSCA MACHO
THREADED MALE COUPLER
MANCHON FILETAGE MÂLE

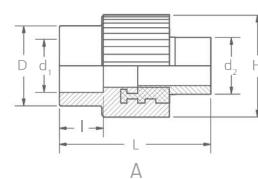

code	type	Ø (mm)	d1 (mm)	d2 (pulg / in)	D (mm)	H (mm)	I (mm)	L (mm)				€/U
828R12520	A	25 x 1/2"	25	1/2"	34,5	39,0	16	56	10	80	6.280	6,919
828R12525	A	25 x 3/4"	25	3/4"	34,5	38,5	16	56	10	80	7.975	9,602

MANGUITO ROSCA MACHO
THREADED MALE COUPLER
MANCHON FILETAGE MÂLE

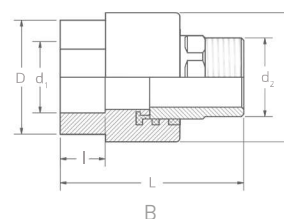

code	type	Ø (mm)	d1 (mm)	d2 (pulg / in)	D (mm)	H (mm)	I (mm)	L (mm)				€/U
828R13225	B	32 x 3/4"	32	3/4"	46	51,5	17,5	60,0	5	40	5.040	9,992
828R13232	B	32 x 1"	32	1"	47	59,0	19,5	68,5	5	30	6.270	16,396
828R14032	B	40 x 1"	40	1"	65	70,5	16,5	65,5	3	18	4.510	20,404
828R14040	B	40 x 1-1/4"	40	1-1/4"	65	75,0	16,5	83,0	3	18	7.650	30,614

MANGUITO ROSCA MACHO
THREADED MALE COUPLER
MANCHON FILETAGE MÂLE

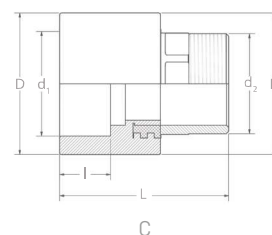

code	type	Ø (mm)	d1 (mm)	d2 (pulg / in)	D (mm)	H (mm)	I (mm)	L (mm)				€/U
828R15050	C	50 x 1-1/2"	50	1-1/2"	68	75,5	23,5	88,0	2	12	5.365	40,301
828R16363	C	63 x 2"	63	2"	82	82,0	29,0	99,5	2	10	5.830	49,977
828R17575	C	75 x 2-1/2"	75	2-1/2"	97	97,0	32,0	103,5	1	6	5.465	82,708
828R19090	C	90 x 3"	90	3"	119	119,0	36,0	130,0	1	3	4.800	144,887
828R10110	C	110 x 4"	110	4"	153	153,0	41,0	158,0	1	2	6.505	232,904

MANGUITO RANURADO INOX
THREADED MALE COUPLER
MANCHON FILETAGE MÂLE

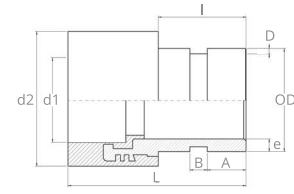

code	∅ (mm)	dimensión Vitaulic	d1 (mm)	d2 (pulg / in)	OD (mm)	A (mm)	B (mm)	D (mm)	e (mm)	L (mm)	I (mm)				€/U
854R54040	40	DN32 1-1/4"	40	65	42,4	15,88	7,14	1,60	5,1	83	36	2	12	5.365	39,962
854R55050	50	DN40 1-1/2"	50	68	48,3	15,88	7,14	1,60	4,7	88	36	2	10	5.830	49,772
854R56363	63	DN50 2"	63	83,5	60,3	15,88	8,74	1,60	4,4	100	40	1	6	5.465	61,386
854R57575	75	DN50 2-1/2"	75	98	73,0	15,88	8,74	1,98	5,1	104	40,5	1	3	4.800	92,234
854R59090	90	DN80 3"	90	119	88,9	15,88	8,74	1,98	4,2	130	50	1	2	6.505	157,597

ENLACE RECTO TUERCA LOCA H.
LOOSE NUT STRAIGHT ADAPTOR
RACCORD DROIT ÉCROU FOU

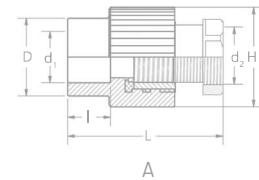

code	type	∅ (mm)	d1 (mm)	d2 (pulg / in)	D (mm)	H (mm)	I (mm)	L (mm)				€/U
827R32525	A	25 x 3/4"	25	3/4"	34,5	40,0	16	55,5	10	60	9.128	11,936
827R32532	A	25 x 1"	25	1"	34,5	44,5	16	57,0	10	40	7.000	17,555

ENLACE RECTO TUERCA LOCA H.
LOOSE NUT STRAIGHT ADAPTOR
RACCORD DROIT ÉCROU FOU

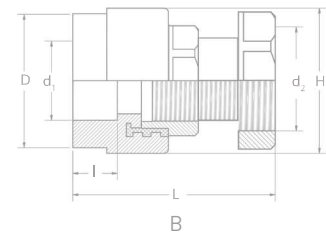

code	type	∅ (mm)	d1 (mm)	d2 (pulg / in)	D (mm)	H (mm)	I (mm)	L (mm)				€/U
827R33232	B	32 x 1"	32	1"	46,0	51,0	18,0	64	5	30	6.000	20,555
827R33240	B	32 x 1-1/4"	32	1-1/4"	47,5	60,5	18,0	84	5	20	8.500	34,395
827R34040	B	40 x 1-1/4"	40	1-1/4"	65,0	71,0	20,5	75	5	15	7.000	40,813

CONECTOR UNIVERSAL
UNIVERSAL ADAPTOR
RACCORD UNIVEREL EN LAITON

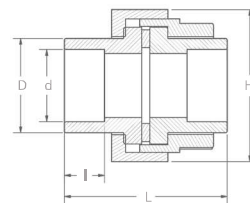
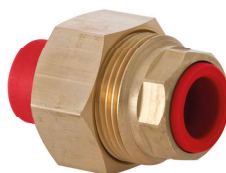

code	∅ (mm)	d (mm)	D (mm)	H (mm)	I (mm)	L (mm)			€/U
846R00032	32	32	41,5	68	18,0	69,5	20	8.000	47,585
846R00040	40	40	53,0	86	20,5	73,5	12	9.500	79,608
846R00050	50	50	58,0	96	23,5	78,0	8	6.400	99,225
846R00063	63	63	73,0	116	27,5	87,0	5	9.412	155,205
846R00075	75	75	88,0	138	30,0	94,0	4	8.500	214,111
846R00090	90	90	109,0	175	33,0	101,0	2	7.548	396,913
846R00110	110	110	130,0	202	37,0	108,0	2	8.340	491,237

CONECTOR ROSCA HEMBRA
THREADED FEMALE ADAPTOR
RACCORD FILETAGE FEMELLE

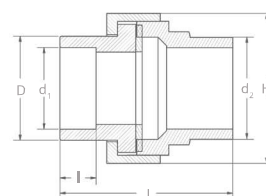

code	∅ (mm)	d1 (mm)	d2 (pulg / in)	D (mm)	H (mm)	I (mm)	L (mm)			€/U
8471R0025	25 x 3/4"	25	3/4"	36	48	16	60	30	8.350	32,160
8471R0032	32 x 1"	32	1"	41,5	54	18	65	20	8.500	47,452
8471R0040	40 x 1-1/4"	40	1-1/4"	53	67	20,5	71	12	8.000	77,837
8471R0050	50 x 1-1/2"	50	1-1/2"	58	76	23,5	85,5	8	7.000	112,875
8471R0063	63 x 2"	63	2"	73	92,5	27,5	96	6	9.330	165,468
8471R0075	75 x 2-1/2"	75	2-1/2"	88	90	30	138	4	9.500	265,223

CONECTOR ROSCA MACHO
THREADED MALE ADAPTOR
RACCORD FILETAGE MÂLE

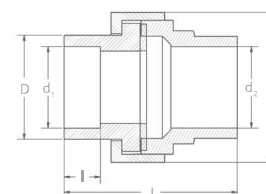
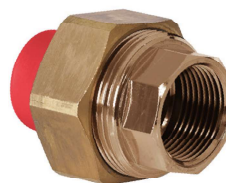

code	∅ (mm)	d1 (mm)	d2 (pulg / in)	D (mm)	H (mm)	I (mm)	L (mm)			€/U
8472R0025	25 x 3/4"	25	3/4"	36,0	54	16,0	58,0	30	8.950	32,160
8472R0032	32 x 1"	32	1"	41,5	68	18,0	57,5	20	8.000	47,452
8472R0050	50 x 1-1/2"	50	1-1/2"	58,0	96	23,5	71,0	8	7.450	112,875
8472R0063	63 x 2"	63	2"	73	116	27,5	75,07	6	8.790	164,181
8472R0075	75 x 2-1/2"	75	2-1/2"	88,0	138	30,0	79,0	4	9.000	204,279

CUELLO BRIDA CON JUNTA
STUB FLANGE WITH GASKET
SUPPORT DE BRIDE AVEC JOINT

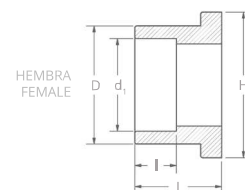

	code	Ø (mm)	d1 (mm)	D (mm)	H (mm)	L (mm)	I1 (mm)				€/U
SOLDADURA SOCKET	8491R0032	32	32	40,5	50,0	33,0	18,0	10	70	2.325	4,442
	8491R0040	40	40	49,5	60,0	35,5	20,5	6	42	2.050	6,289
	8491R0050	50	50	59,0	71,5	37,5	23,5	4	24	1.790	9,989
	8491R0063	63	63	76	101	41	27,4	2	16	2.400	11,993
	8491R0075	75	75	89,1	121,9	45,9	30,4	2	12	2.830	13,994
	8491R0090	90	90	109,0	137,0	49,5	33,0	1	7	2.145	21,992
	8491R0110	110	110	130,0	156,0	52,5	37,0	1	5	2.005	29,981
	8491R0125	125	125	163,0	186,5	65,0	40,0	1	2	7.799	55,374

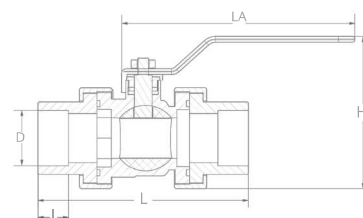

**LLAVE BOLA DESMONTABLE
 CON CUELLO BRIDA**
BRASS BALL STOPCOCK VALVE
VANNE À BOISSEAU



code	Ø (mm)	D (mm)	H (mm)	I (mm)	L (mm)	LA (mm)			€/U
83642R025	25	25	78,5	16,0	111,5	103,0	25	11.500	28,985
83642R032	32	32	89,5	18,0	120,0	121,0	15	11.000	42,029
83642R040	40	40	106,0	20,5	138,0	151,5	8	9.320	70,769
83642R050	50	50	125,5	23,5	148,5	162,0	6	11.000	115,796
83642R063	63	63	150,5	27,5	164,0	165,5	3	9.000	182,406

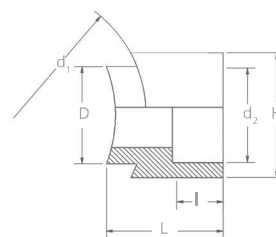

DERIVACIÓN SALIDA HEMBRA
FEMALE SADDLE ADAPTOR
RACCORD CAVALIER FEMELLE

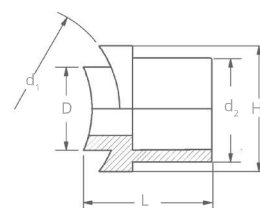

code	Ø (mm)	d1 (mm)	d2 (mm)	D (mm)	H (mm)	I (mm)	L (mm)				€/U
840R04025	40 - 25	40	25	20-25	38,0	16,0	41,5	5	75	1.735	2,995
840R05025	50 - 25	50	25	20-25	38,0	16,0	37,5	5	75	1.685	2,995
840R06325	63 - 25	63	25	20-25	38,5	16,0	38,0	5	75	1.695	2,995
840R07525	75 - 25	75	25	20-25	37,5	16,0	40,0	5	75	1.745	2,995
840R09025	90 - 25	90	25	20-25	38,0	16,0	40,5	5	60	1.496	2,995
840R11025	110 - 25	110	25	20-25	39,0	16,0	41,0	5	45	1.134	2,995
840R12525	125 - 25	125	25	20-25	37,5	16,0	44,0	5	50	1.307	2,995
840R16025	160 - 25	160	25	20-25	38,0	16,0	47,0	5	70	1.812	2,995
840R06332	63 - 32	63	32	32	42,5	18,0	42,5	5	75	2.380	4,004
840R07532	75 - 32	75	32	32	42,5	18,0	41,5	5	60	1.920	4,004
840R09032	90 - 32	90	32	32	42,5	18,0	43,0	5	45	1.520	4,004
840R11032	110 - 32	110	32	32	42,5	18,0	44,0	5	45	1.520	4,004
840R12532	125 - 32	125	32	32	42,5	18,0	48,0	5	45	1.595	4,004
840R16032	160 - 32	160	32	32	42,5	18,0	50,0	5	70	2.573	4,004
840R07540	75 - 40	75	40	40	51,5	20,5	47,0	5	50	2.980	5,273
840R09040	90 - 40	90	40	40	51,5	20,5	46,5	5	35	1.870	5,273
840R11040	110 - 40	110	40	40	51,5	20,5	48,0	5	35	2.006	5,273
840R12540	125 - 40	125	40	40	51,5	20,5	52,5	5	40	2.389	5,273
840R16040	160 - 40	160	40	40	51,5	20,5	54,0	5	40	2.426	5,273
840R11050	110 - 50	110	50	50	68,0	23,5	51,5	5	25	2.385	5,948
840R12550	125 - 50	125	50	50	67,5	23,5	53,0	3	27	2.625	5,948
840R16050	160 - 50	160	50	50	68,0	23,5	54,5	5	20	2.142	5,948
840R11063	110 - 63	110	63	63	83,5	27,5	60,0	6	12	1.920	10,088
840R12563	125 - 63	125	63	63	82,0	27,5	60,5	3	15	2.395	10,088
840R16063	160 - 63	160	63	63	82,0	27,5	61,0	4	16	2.727	10,088

DERIVACIÓN SALIDA MACHO
MALE SADDLE ADAPTOR
RACCORD CAVALIER MÂLE



code	Ø (mm)	d1 (mm)	d2 (mm)	D (taladro) (mm)	H (mm)	L (mm)			€/U
841R11063	110 - 63	110	63	50,0	67,0	87,0	12	1.630	18,693
841R12563	125 - 63	125	63	50,0	67,0	80,0	12	1.440	18,235
841R16063	160 - 63	160	63	50,0	67,0	82,0	12	1.630	18,235
841R11075	110 - 75	110	75	63,0	82,0	95,0	12	2.350	22,363
841R12575	125 - 75	125	75	63,0	82,0	90,0	12	2.230	21,817
841R16075	160 - 75	160	75	63,0	82,0	95,0	12	2.230	21,817
841R12590	125 - 90	125	90	75,0	101,5	111,5	6	2.700	26,434
841R16090	160 - 90	160	90	75,0	101,0	103,5	6	1.800	26,434
841R16011	160 - 110	160	110	87,0	120,0	113,0	3	1.580	46,772

(1) En la matriz soldasientos, seleccione el diámetro (D) inmediatamente inferior al diámetro (d2) de la derivación.
 (1) In the saddle dies, select the diameter (D) immediately smaller than the diameter (d2) of the saddle adaptor.
 (1) Dans la matrice de derivation, sélectionner le diamètre (D) immédiatement inférieur au diamètre (d2) du raccord cavalier

DERIVACIÓN ROSCA HEMBRA

THREADED FEMALE SADDLE ADAPTOR

RACCORD CAVALIER FILETAGE FEMELLE

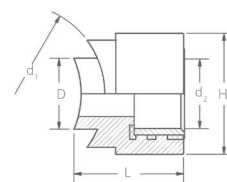

code	Ø (mm)	d1 (mm)	d2 (pulg / in)	D (mm)	H (mm)	L (mm)				€/U
8451R4012	40 x 1/2"	40	1/2"	20 - 25	37,5	42,0	5	75	4.150	7,588
8451R5012	50 x 1/2"	50	1/2"	20 - 25	38,0	37,5	5	75	4.130	7,588
8451R6312	63 x 1/2"	63	1/2"	20 - 25	38,0	39,0	5	75	4.145	7,588
8451R7512	75 x 1/2"	75	1/2"	20 - 25	38,5	39,5	5	75	4.210	7,588
8451R9012	90 x 1/2"	90	1/2"	20 - 25	38,0	40,5	5	75	4.727	7,588
8451R1012	110 x 1/2"	110	1/2"	20 - 25	38,0	42,0	5	75	4.759	7,588
8451R2512	125 x 1/2"	125	1/2"	20 - 25	38,0	43,5	5	70	4.100	7,588
8451R6012	160 x 1/2"	160	1/2"	20 - 25	38,0	47,5	5	70	4.637	7,588
8451R4034	40 x 3/4"	40	3/4"	20 - 25	43,0	41,5	5	75	5.520	9,704
8451R5034	50 x 3/4"	50	3/4"	20 - 25	42,5	37,5	5	65	4.770	9,704
8451R6334	63 x 3/4"	63	3/4"	20 - 25	43,0	38,5	5	65	4.550	9,704
8451R7534	75 x 3/4"	75	3/4"	20 - 25	43,0	40,0	5	65	5.411	9,704
8451R9034	90 x 3/4"	90	3/4"	20 - 25	43,0	40,5	5	70	5.100	9,704
8451R1034	110 x 3/4"	110	3/4"	20 - 25	43,0	41,5	5	70	5.275	9,704
8451R2534	125 x 3/4"	125	3/4"	20 - 25	43,0	43,5	5	70	5.750	9,704
8451R6034	160 x 3/4"	160	3/4"	20 - 25	42,5	47,0	5	70	5.965	9,704
8451R7532	75 x 1"	75	1"	40	57,0	51,0	5	40	9.466	19,090
8451R9032	90 x 1"	90	1"	40	57,0	52,0	5	35	7.838	19,090
8451R1032	110 x 1"	110	1"	40	57,0	52,0	5	35	9.238	19,090
8451R2532	125 x 1"	125	1"	40	57,0	56,0	5	35	8.608	19,090
8451R6032	160 x 1"	160	1"	40	57,0	57,5	5	30	7.450	19,090

DERIVACIÓN ROSCA MACHO

THREADED MALE SADDLE ADAPTOR

RACCORD CAVALIER FILETAGE MÂLE

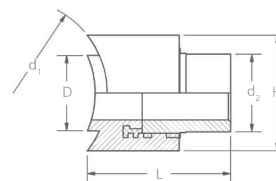

code	Ø (mm)	d1 (mm)	d2 (pulg/in)	D (taladro) (mm)	H (mm)	L (mm)				€/U
8452R6312	63 x 1/2"	63	1/2"	20 - 25	36,00	59,50	5	75	9.504	9,704
8452R7512	75 x 1/2"	75	1/2"	20 - 25	36,00	59,50	5	75	9.461	12,398
8452R9012	90 x 1/2"	90	1/2"	20 - 25	36,00	59,50	5	75	9.643	12,398
8452R6334	63 x 3/4"	63	3/4"	20 - 25	39,00	59,50	5	75	12.220	14,772
8452R7534	75 x 3/4"	75	3/4"	20 - 25	39,00	59,50	5	75	12.220	15,748
8452R9034	90 x 3/4"	90	3/4"	20 - 25	39,00	59,50	5	75	12.428	15,748

TAPÓN DE REPARACIÓN
REPAIR CAP
BOUCHON DE RÉPARATION

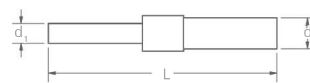

code	∅ (mm)	d1 (mm)	d2 (mm)	L (mm)				€/U
843R00711	7 x 11	7	11	83	100	400	2.500	1,246

CODO 90° SEGMENTADO TOPE
90° SEGMENTED BUTT WELD ELBOW
COUDE SEGMENTÉ À 90° BOUT À BOUT

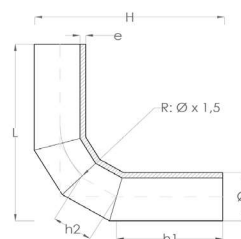

code	∅ (mm)	R (mm)	e (mm)	h1 (mm)	h2 (mm)	L=H (mm)				€/U
1822R00161	160	240	14,6	215	127	470	1	1	1.884	(1)

(1) Bajo demanda. Consultar precio y disponibilidad. / (1) On request. Check availability and price. / (1) Sur demande vérifier le prix et la disponibilité

(2) Todas las referencias son SDR 11(2) / All references are SDR 11 / (2) Toutes les références sont SDR 11

CODO 45° SEGMENTADO TOPE
45° SEGMENTED BUTT WELD ELBOW
COUDE SEGMENTÉ À 45° BOUT À BOUT

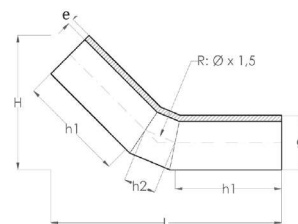

code	∅ (mm)	R (mm)	e (mm)	h1 (mm)	h2 (mm)	L (mm)	H (mm)				€/U
823R00161	160	240	14,6	198	95	483	313	1	1	2.076	(1)

(1) Bajo demanda. Consultar precio y disponibilidad. / (1) On request. Check availability and price. / (1) Sur demande vérifier le prix et la disponibilité

(2) Todas las referencias son SDR 11(2) / All references are SDR 11 / (2) Toutes les références sont SDR 11

TE TOPE LARGA SEGMENTADA
LONG BUTT WELD SEGMENTED TEE
TÉ LONGUE BOUT À BOUT SEGMENTÉ

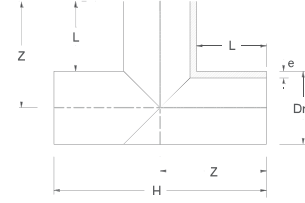

code	∅ (mm)	R (mm)	e (mm)	h1 (mm)	h2 (mm)	L (mm)	H (mm)				€/U
824R00161	160	141	160	14,6	240	160	480	1	1	3.259	(1)

(1) Bajo demanda. Consultar precio y disponibilidad. / (1) On request. Check availability and price. / (1) Sur demande vérifier le prix et la disponibilité

TE REDUCIDA DERIVACIÓN MACHO
BUTT WELD REDUCER TEE
TÉ DE RÉDUCTION BOUT À BOUT

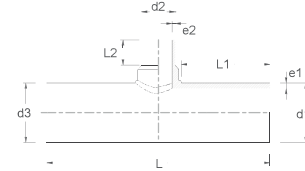

code	∅ (mm)	d1 (mm)	e1 (mm)	d2 (mm)	e2 (mm)	L (mm)	Z (mm)	h (mm)				€/U
825R75125	125 x 75 x 125	125	11,4	75	6,8	580	209	75	1	1	2.196	(1)
825R90125	125 x 90 x 125			90	8,2				2.750	(1)		
825R90160	160 x 90 x 160	160	14,6	90	8,2	580	209	75	1	1	3.811	(1)
825R11160	160 x 110 x 160			110	10,0				3.900	(1)		

(1) Bajo demanda. Consultar precio y disponibilidad. / (1) On request. Check availability and price. / (1) Sur demande vérifier le prix et la disponibilité

CUELLO BRIDA TOPE LARGO
LONG STUB FLANGE
SUPPORT DE BRIDE LONGUE BOUT À BOUT

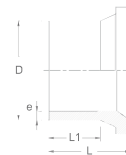

code ¹	∅ (mm)	D (mm)	e (mm)	L (mm)	L1 (mm)				€/U
8491R0160	160	160	14,5	180,1	104,6	1	12	16.620	101,308

(2) Ninguno incluye junta / (2) Gasket not included in any reference / (2) Aucun n'inclut de joint
 (3) El ángulo del chafalán en todas las referencias es ≈60° / (3) The chamfer angle in all references is ≈60° / (3) L'angle du chanfrein sur toutes les références est ≈60°
 (4) Presión de trabajo SDR11 / (4) Working pressure SDR11 / (4) Pression de service SDR11