

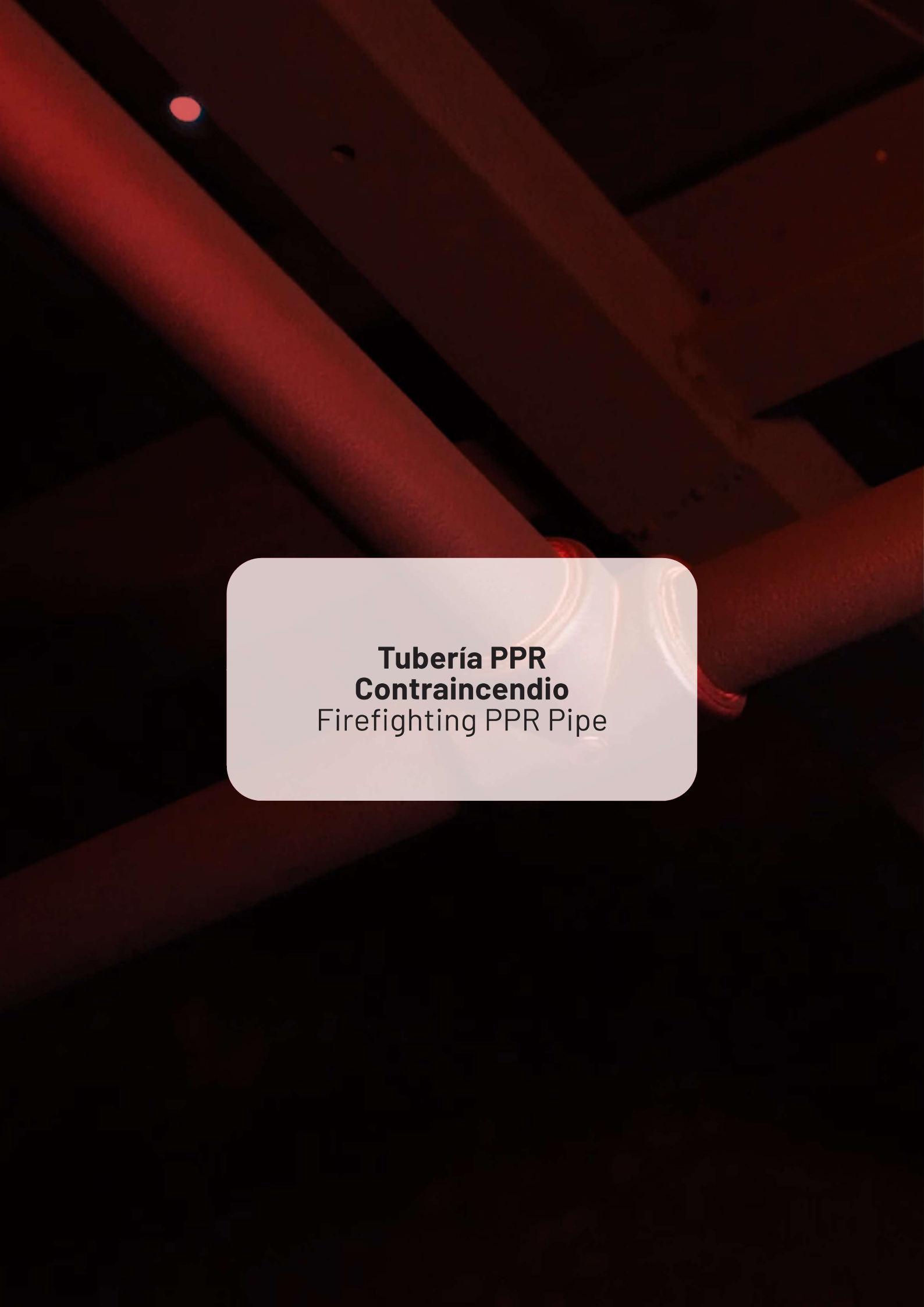



# Sistema FIRE

## FIRE System



**Tubería PPR**  
**Contraincendio**  
Firefighting PPR Pipe



## REPOLEN FASER FIRE RP

SERIE 3,2 SDR7,4 PN16  
SERIE 5 SDR 11 PN10



**Estructura** MCF (MULTICAPA FV, FASER)  
**Material** PP-RCT FIRE REPOLEN  
**Normativa** UNE EN 15874; UNE EN ISO 21003; DIN 8077; UNE 23500; UNE EN 671; UNE EN 12845; CTE; RIPCI; RSCIEI  
**Color** INTERIOR VERDE RAL 6024  
EXT. ROJO RAL 3028  
**Suministro** BARRAS 4M / EMBOLSADO

**Structure** MCF (MULTILAYER GF, FASER)  
**Material** PP-RCT FIRE REPOLEN  
**Regulations** UNE EN 15874; UNE EN ISO 21003; DIN 8077; UNE 23500; UNE EN 671; UNE EN 12845; CTE; RIPCI; RSCIEI  
**Colour** INNER GREEN RAL 6024  
OUTER RED RAL 3028  
**Supply** 4M LENGTH / BAGGED

**Structure** MCF (MULTICOUCHE FV, FASER)  
**Matériel** PP-RCT FIRE REPSOL  
**Norme** UNE EN 15874; UNE EN ISO 21003; DIN 8077; UNE 23500; UNE EN 671; UNE EN 12845; CTE; RIPCI; RSCIEI  
**Couleur** INTÉRIEUR VERT RAL 6024  
EXT. ROUGE RAL 3028  
**Fourniture** BARRES 4 M / ENSACHÉ

S - SDR	código	d	di	e	capacidad (L/m)	m/paquetes	peso (kg/m)	paquetes palet	€/m
	code	(mm)	(mm)	(mm)	capacity (L/m)	m/bags	weight (kg/m)	packs palet	
3,2 - 7,4	431500006	25	20,4	3,5	0,254	80	0,260	28	5,256
	430500005	32	26,2	2,9	0,539	60	0,297	23	6,958
5 - SDR 11	430500004	40	32,6	3,7	0,835	40	0,463	23	10,775
	430500009	50	40,8	4,6	1,307	20	0,718	28	15,828
	430500010	63	51,4	5,8	2,075	12	1,093	30	24,452
	430500011	75	61,4	6,8	2,961	12	1,553	23	33,347
	430500012	90	73,6	8,2	4,254	8	2,262	20	47,718
	430500013	110	90	10	6,362	4	3,360	27	64,784
	430500014	125	102,2	11,4	8,203	4	4,301	20	89,583
	430500016	160	130,8	14,6	13,437	4	6,821	12	132,790

A collection of various red PPR (Polypropylene Random Copolymer) firefighting fittings and pipe sections is scattered across a dark, almost black background. The items include several large, rounded, bell-shaped components, likely elbows or tees, and several smaller, cylindrical pipe sections. One pipe section on the left shows a green interior lining. Another pipe section on the right has the letters 'PPR' visible on its side. The lighting is dramatic, highlighting the smooth, matte texture of the plastic and casting deep shadows.

**Accesorios PPR  
contra incendios**  
Firefighting PPR Fittings

**CODO 90°HEMBRA/HEMBRA**  
**90° FEMALE/FEMALE ELBOW**  
**COUDE 90° FEMELLE/FEMELLE**

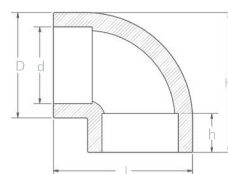

code	Ø (mm)	d (mm)	D (mm)	h (mm)	H (mm)	L (mm)				€/U
822R02525	25	25	34,5	16,0	44,5	46,0	10	100	2.670	0,929
822R03232	32	32	42,3	18,4	59,9	55,6	10	50	2.150	1,550
822R04040	40	40	54,9	21,6	71,3	71,5	6	24	2.380	2,883
822R05050	50	50	68,5	23,5	83,0	83,0	4	12	1.990	6,154
822R06363	63	63	84,5	27,5	101,0	100,0	2	6	1.885	9,841
822R07575	75	75	99,5	30,0	119,5	119,0	1	3	1.550	16,632
822R09090	90	90	120,4	35,9	142,2	142,6	1	3	2.970	31,992
822R00110	110	110	146,5	37,0	172,0	176,5	1	4	7.055	53,663
822R00125	125	125	162,0	40,0	181,0	181,0	1	2	3.930	80,405

**CODO 45°HEMBRA/HEMBRA**  
**45° FEMALE/FEMALE ELBOW**  
**COUDE 45° FEMELLE/FEMELLE**

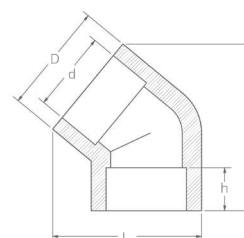

code	Ø (mm)	d (mm)	D (mm)	h (mm)	H (mm)	L (mm)				€/U
823R02525	25	25	36,0	16,0	60,0	50,0	10	80	2.305	1,165
823R03232	32	32	45,0	18,0	72,0	60,0	10	40	2.255	1,636
823R04040	40	40	55,5	20,5	83,0	71,0	6	24	2.360	3,238
823R05050	50	50	65,5	23,5	89,5	79,0	3	15	1.965	5,535
823R06363	63	63	84,0	27,5	97,0	96,5	2	8	2.050	9,897
823R07575	75	75	98,5	30,0	114,5	115,0	1	4	1.610	14,539
823R09090	90	90	121,5	33,0	133,0	139,0	1	3	2.115	34,316
823R00110	110	110	150,0	37,0	167,5	173,0	1	4	5.020	52,782
823R00125	125	125	162,0	40,0	184,5	188,0	1	4	4.600	77,044

**MANGUITO**  
**COUPLER**  
**MANCHON**

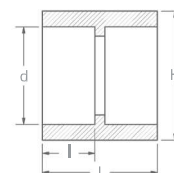

code	Ø (mm)	d (mm)	H (mm)	l (mm)	L (mm)				€/U
821R02525	25	25	33,0	16,0	37,0	10	100	1.670	0,861
821R03232	32	32	43,5	18,0	42,5	10	70	2.410	1,212
821R04040	40	40	52,0	20,5	46,0	6	42	2.100	2,130
821R05050	50	50	68,5	23,5	55,5	3	18	2.100	4,024
821R06363	63	63	83,5	27,5	61,5	3	15	2.460	6,357
821R07575	75	75	99,0	30,0	66,5	2	10	2.560	9,718
821R09090	90	90	119,0	33,0	74,0	2	6	2.490	19,421
821R00110	110	110	154,5	37,0	88,0	1	4	3.565	32,386
821R00125	125	125	163,0	40,0	90,0	1	6	4.780	42,105

**REDUCCIÓN MACHO/HEMBRA**  
**MALE/FEMALE REDUCER PIPE**  
**RÉDUCTION MÂLE/FEMELLE**

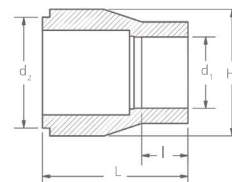

code	Ø (mm)	d2 (mm)	d1 (mm)	H (mm)	I (mm)	L (mm)				€/U
820R13225	32 x 25	32	25	33,0	16,0	45,0	10	100	2.050	0,975
820R14025	40 x 25	40	25	41,0	16,0	49,0	6	60	2.195	1,919
820R14032	40 x 32	40	32	43,0	18,0	49,0	6	60	2.375	2,217
820R15025	50 x 25	50	25	50,0	16,0	53,0	3	36	1.810	3,686
820R15032	50 x 32	50	32	50,5	18,0	53,5	3	36	2.015	3,686
820R15040	50 x 40	50	40	52,0	20,5	56,0	3	30	2.085	3,686
820R16325	63 x 25	63	25	63,5	16,0	63,5	3	30	2.771	5,377
820R16332	63 x 32	63	32	63,5	18,0	63,5	3	30	2.690	5,377
820R16340	63 x 40	63	40	63,5	20,5	64,0	3	24	2.390	7,360
820R16350	63 x 50	63	50	68,5	23,5	63,5	3	15	1.875	7,644
820R17532	75 x 32	75	32	75,5	18,0	66,5	2	20	2.655	7,235
820R17540	75 x 40	75	40	76,0	20,5	67,0	2	20	2.790	8,808
820R17550	75 x 50	75	50	75,5	23,5	66,5	2	16	2.480	8,808
820R17563	75 x 63	75	63	84,5	27,5	69,5	2	16	3.090	9,003
820R19063	90 x 63	90	63	90,0	27,5	76,0	2	8	2.090	17,178
820R19075	90 x 75	90	75	99,5	30,0	79,5	1	8	2.550	17,874
820R11063	110 x 63	110	63	110,0	27,5	84,0	1	6	2.295	18,441
820R11075	110 x 75	110	75	110,5	30,0	89,0	1	3	1.365	18,441
820R11090	110 x 90	110	90	118,5	33,0	98,5	1	3	1.755	24,003

**REDUCCIÓN HEMBRA/HEMBRA**  
**FEMALE/FEMALE REDUCER PIPE**  
**RÉDUCTION FEMELLE/FEMELLE**

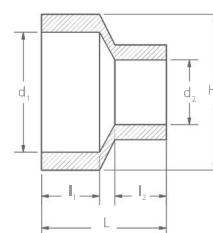

code	Ø (mm)	d1 (mm)	d2 (mm)	H (mm)	I1 (mm)	I2 (mm)	L (mm)				€/U
820R03225	32 x 25	32	25	41,5	18,0	16,0	42,0	10	90	2.240	2,069
820R04032	40 x 32	40	32	51,0	20,5	18,0	45,0	6	60	2.411	2,158
820R05040	50 x 40	50	40	68,5	23,5	20,5	59,5	3	15	1.915	5,328
820R06350	63 x 50	63	50	83,0	27,5	23,5	61,0	3	15	2.910	8,275
820R07563	75 x 63	75	63	99,0	30,0	27,5	66,0	2	8	2.554	14,131
820R09075	90 x 75	90	75	119,5	33,0	30,0	72,0	2	6	2.943	23,235

**TE LISA HEMBRA**  
**FEMALE TEE**  
**TÉ SIMPLE**

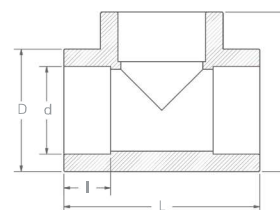

code	Ø (mm)	d (mm)	D (mm)	H (mm)	I (mm)	L (mm)				€/U
824R02525	25	25	35,0	48,0	16,0	61,0	10	60	2.470	1,151
824R03232	32	32	45,0	58,5	18,0	74,5	5	30	2.245	2,083
824R04040	40	40	55,0	70,0	20,5	86,0	6	18	2.360	3,304
824R05050	50	50	69,5	84,0	23,5	98,0	2	12	2.640	7,512
824R06363	63	63	83,5	101,5	27,5	115,0	1	6	2.130	13,348
824R07575	75	75	98,0	116,5	30,0	138,5	1	3	1.715	16,750
824R09090	90	90	123,0	138,5	33,0	157,5	1	3	3.260	38,494
824R00110	110	110	145,0	166,5	37,0	192,5	1	4	6.785	63,666
824R00125	125	125	164,5	182,0	40,0	208,0	1	2	4.815	88,093



**TE REDUCIDA HEMBRA**  
**FEMALE REDUCER TEE**  
**TÉ RÉDUCTION**

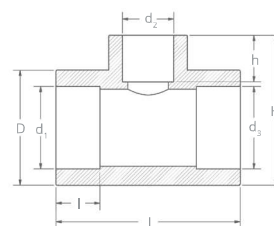

code	∅ (mm)	d1 (mm)	d2 (mm)	d3 (mm)	D (mm)	h (mm)	H (mm)	I (mm)	L (mm)			GR BOX	€/U
825R22532	32 x 25 x 32	32	25	32	43,0	16,0	58,5	18,0	74,5	5	30	2.210	3,187
825R02540	40 x 25 x 40	40	25	40	55,0	16,0	73,0	20,5	86,5	6	18	2.285	3,864
825R03240	40 x 32 x 40	40	32	40	55,0	18,0	70,5	20,5	86,0	6	18	2.565	3,864
825R02550	50 x 25 x 50	50	25	50	65,5	16,0	76,5	23,5	95,5	2	12	2.160	7,881
825R03250	50 x 32 x 50	50	32	50	66,0	18,0	76,0	23,5	96,0	2	12	2.075	7,881
825R04050	50 x 40 x 50	50	40	50	68,5	20,5	85,0	23,5	98,5	2	12	2.855	8,745
825R32563	63 x 25 x 63	63	25	63	82,5	16,0	87,5	27,5	115,5	2	8	2.540	13,217
825R33263	63 x 32 x 63	63	32	63	82,5	18,0	92,5	27,5	115,5	2	8	2.525	13,217
825R34063	63 x 40 x 63	63	40	63	83,0	20,5	92,5	27,5	115,0	2	8	2.525	13,217
825R35063	63 x 50 x 63	63	50	63	83,0	23,5	95,5	27,5	115,0	2	8	2.315	13,737
825R53275	75 x 32 x 75	75	32	75	98,5	18,0	106,0	30,0	127,0	1	4	2.250	22,029
825R54075	75 x 40 x 75	75	40	75	100,0	20,5	108,5	30,0	126,0	1	4	2.200	22,029
825R55075	75 x 50 x 75	75	50	75	99,0	23,5	109,0	30,0	126,5	1	4	2.210	22,029
825R56375	75 x 63 x 75	75	63	75	98,5	27,5	116,0	30,0	137,5	1	3	1.905	24,184
825R05090	90 x 50 x 90	90	50	90	122,0	23,5	133,5	33,0	157,5	1	3	3.325	39,655
825R06390	90 x 63 x 90	90	63	90	121,0	27,5	134,0	33,0	157,5	1	3	3.175	39,655
825R07590	90 x 75 x 90	90	75	90	122,0	30,0	138,5	33,0	157,5	1	3	3.450	39,655
825R11063	110 x 63 x 110	110	63	110	147,0	27,5	149,5	37,0	175,0	1	2	2.850	62,677
825R11075	110 x 75 x 110	110	75	110	147,5	30,0	163,0	37,0	177,5	1	2	3.230	62,677
825R11090	110 x 90 x 110	110	90	110	148,5	33,0	164,0	37,0	177,5	1	2	3.030	62,677

**CRUZ REDUCIDA HEMBRA**  
**FEMALE REDUCING CROSS**  
**CROIX RÉDUITE FEMELLE**

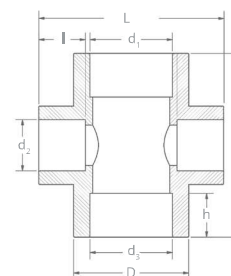

code <sup>1</sup>	∅ (mm)	d1 (mm)	d2 (mm)	d3 (mm)	D (mm)	h (mm)	H (mm)	I (mm)	L (mm)			GR BOX	€/U
853R15032	50 x 32 x 50	50	32	50	66,0	23,5	-	18,0	96,0	2	8	2.122	20,407
853R16332	63 x 32 x 63	63	32	63	82,5	27,5	-	18,0	115,5	1	6	2.050	23,495
853R16340	63 x 40 x 63	63	40	63	83,0	27,5	92,5	20,5	115,0	1	6	2.036	23,741
853R17532	75 x 32 x 75	75	32	75	98,5	30,0	106,0	18,0	127,0	1	4	2.362	31,318
853R17540	75 x 40 x 75	75	40	75	100,0	30,0	108,5	20,5	126,0	1	3	2.381	32,252
853R17550	75 x 50 x 75	75	50	75	99,0	30,0	109,0	23,5	126,5	1	3	1.791	37,770
853R19050	90 x 50 x 90	90	50	90	122,0	33,0	133,5	23,5	157,5	1	3	3.494	50,754

(1) Accesorio manipulado garantía y compatibilidad con todos los accesorios del sistema REPOLEN FIRE RP / (1) Handled fitting, guaranteed and compatible with all accessories of the REPOLEN FIRE RP system / (1) Accessoire manipulé, garanti et compatible avec tous les accessoires du système REPOLEN FIRE RP

**TAPÓN**  
**END CAP**  
**BOUCHON**

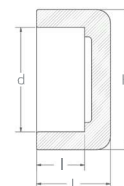

	code	Ø (mm)	d (mm)	H (mm)	l (mm)	L (mm)				€/U
SOLDADURA SOCKET	826R02525	25	25	32,0	16,0	30,5	10	150	2.330	1,014
	826R03232	32	32	44,5	18,0	32,0	10	80	2.515	1,902
	826R04040	40	40	52,0	20,5	30,0	6	60	2.415	2,566
	826R05050	50	50	65,0	23,5	34,0	3	36	2.510	5,197
	826R06363	63	63	82,0	27,5	43,0	3	21	2.915	6,598
	826R07575	75	75	98,0	30,0	52,0	2	12	2.805	11,065
	826R09090	90	90	119,0	33,0	65,0	1	7	3.240	22,662
	826R00110	110	110	144,5	37,0	63,5	1	5	3.050	31,919
	1826R25160	125	125	160,0	40,0	65,0	1	4	3.435	46,710

(1) Tapón válido para soldar a socket en Ø125mm y para soldar a tope en Ø160 mm / (1) End cap suitable for socket fusion welding in Ø125mm and for butt fusion welding in Ø160mm / (1) Bouchon adapté au soudage par emboîtement en Ø125mm et au soudage bout à bout en Ø160mm

**CODO 90° ROSCA HEMBRA**  
**90° THREADED FEMALE ELBOW**  
**COUDE 90° FILETAGE FEMELLE**

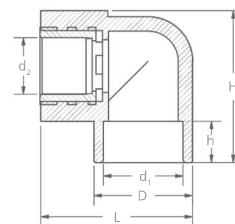

	code	Ø (mm)	d1 (mm)	d2 (pulg / in)	D (mm)	h (mm)	H (mm)	L (mm)				€/U
	830R22520	25 x 1/2"	25	1/2"	36,0	16	56,0	55,5	10	60	4.520	6,478
	830R22525	25 x 3/4"	25	3/4"	35,5	16	53,5	64,5	5	50	4.720	7,833
	830R23225	32 x 3/4"	32	3/4"	45,5	18	62,5	63,0	5	40	4.385	8,631
	830R23232	32 x 1"	32	1"	44,0	18	66,5	79,5	5	20	5.430	16,354

**TE ROSCA HEMBRA**  
**THREADED FEMALE TEE**  
**TÉ FILETAGE FEMELLE**



	code	Ø (mm)	d1 (mm)	d2 (pulg / in)	D (mm)	H (mm)	l (mm)	L (mm)				€/U
	829R22520	25 x 1/2" x 25	25	1/2"	35,5	53,5	16,0	67,5	10	50	4.200	6,883
	829R22525	25 x 3/4" x 25	25	3/4"	35,0	56,5	16,0	63,0	10	40	3.875	8,442
	829R23225	32 x 3/4" x 32	32	3/4"	42,5	67,5	18,0	74,5	5	25	3.205	9,432
	829R24020	40 x 1/2" x 40	40	1/2"	55,0	73,0	21,0	86,0	5	20	3.230	11,422
	829R23232	32 x 1" x 32	32	1"	45,0	77,5	18,0	74,5	4	20	3.562	17,114
	829R25025	50 x 3/4" x 50	50	3/4"	65,5	75,5	23,5	95,5	2	12	2.784	16,712
	829R26325	63 x 3/4" x 63	63	3/4"	82,0	102,0	27,5	115,0	2	6	2.482	26,829

**MANGUITO ROSCA HEMBRA**  
**THREADED FEMALE COUPLER**  
**MANCHON FILETAGE FEMELLE**

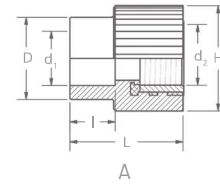

code	type	∅ (mm)	d1 (mm)	d2 (pulg / in)	D (mm)	H (mm)	I (mm)	L (mm)				€/U
827R22520	A	25 x 1/2"	25	1/2"	34,5	40,0	16	42,0	10	90	5.770	5,336
827R22525	A	25 x 3/4"	25	3/4"	34,5	44,5	16	40,5	10	80	5.730	6,023

**MANGUITO ROSCA HEMBRA**  
**THREADED FEMALE COUPLER**  
**MANCHON FILETAGE FEMELLE**

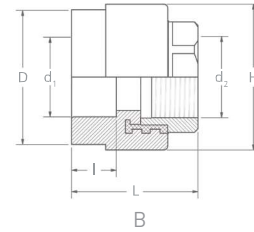

code	type	∅ (mm)	d1 (mm)	d2 (pulg / in)	D (mm)	H (mm)	I (mm)	L (mm)				€/U
827R23220	B	32 x 1/2"	32	1/2"	46,0	51,5	18	44,5	5	50	4.250	7,697
827R23225	B	32 x 3/4"	32	3/4"	46,0	51,5	18,0	44,5	5	50	4.480	8,773
827R23232	B	32 x 1"	32	1"	47,5	60,5	18,0	60,5	5	30	7.120	17,163
827R24032	B	40 x 1"	40	1"	64,5	71,0	20,5	56,5	3	24	6.535	20,577
827R24040	B	40 x 1-1/4"	40	1-1/4"	65,0	75,0	20,5	61,5	3	18	5.925	30,346
827R24020	B	40 x 1/2"	-	-	-	-	-	-	5	40	4.110	35,531

**MANGUITO ROSCA HEMBRA**  
**THREADED FEMALE COUPLER**  
**MANCHON FILETAGE FEMELLE**

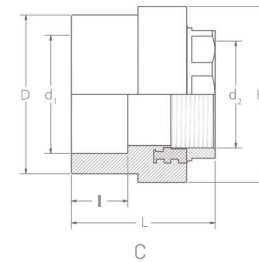

code	type	∅ (mm)	d1 (mm)	d2 (pulg / in)	D (mm)	H (mm)	I (mm)	L (mm)				€/U
827R25050	C	50 x 1-1/2"	50	1-1/2"	68,0	80,5	23,5	66,5	3	15	6.215	35,531
827R26363	C	63 x 2"	63	2"	83,5	92,5	27,5	77,5	2	8	4.165	44,706
827R27575	C	75 x 2-1/2"	75	2-1/2"	98,0	119,5	30,0	79,5	1	6	5.290	79,325
827R29090	C	90 x 3"	90	3"	119,0	143,0	33,0	102,5	1	3	5.165	145,235
827R20110	C	110 x 4"	110	4"	154,0	157,5	37,0	119,0	1	3	6.270	163,301

**MANGUITO ROSCA MACHO**  
**THREADED MALE COUPLER**  
**MANCHON FILETAGE MÂLE**

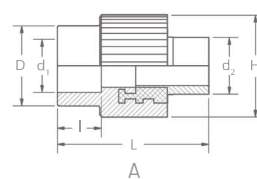

code	type	Ø (mm)	d1 (mm)	d2 (pulg / in)	D (mm)	H (mm)	I (mm)	L (mm)				€/U
828R12520	A	25 x 1/2"	25	1/2"	34,5	39,0	16	56	10	80	6.280	7,473
828R12525	A	25 x 3/4"	25	3/4"	34,5	38,5	16	56	10	80	7.975	10,370

**MANGUITO ROSCA MACHO**  
**THREADED MALE COUPLER**  
**MANCHON FILETAGE MÂLE**

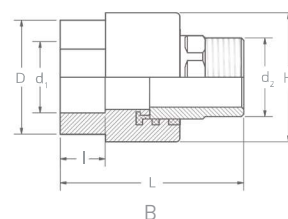

code	type	Ø (mm)	d1 (mm)	d2 (pulg / in)	D (mm)	H (mm)	I (mm)	L (mm)				€/U
828R13225	B	32 x 3/4"	32	3/4"	46	51,5	17,5	60,0	5	40	5.040	10,791
828R13232	B	32 x 1"	32	1"	47	59,0	19,5	68,5	5	30	6.270	17,708
828R14032	B	40 x 1"	40	1"	65	70,5	16,5	65,5	3	18	4.510	22,036
828R14040	B	40 x 1-1/4"	40	1-1/4"	65	75,0	16,5	83,0	3	18	7.650	33,063

**MANGUITO ROSCA MACHO**  
**THREADED MALE COUPLER**  
**MANCHON FILETAGE MÂLE**

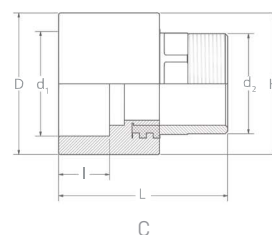

code	type	Ø (mm)	d1 (mm)	d2 (pulg / in)	D (mm)	H (mm)	I (mm)	L (mm)				€/U
828R15050	C	50 x 1-1/2"	50	1-1/2"	68	75,5	23,5	88,0	2	12	5.365	43,525
828R16363	C	63 x 2"	63	2"	82	82,0	29,0	99,5	2	10	5.830	53,975
828R17575	C	75 x 2-1/2"	75	2-1/2"	97	97,0	32,0	103,5	1	6	5.465	89,325
828R19090	C	90 x 3"	90	3"	119	119,0	36,0	130,0	1	3	4.800	156,478
828R10110	C	110 x 4"	110	4"	153	153,0	41,0	158,0	1	2	6.505	251,536

**MANGUITO RANURADO INOX**  
**THREADED MALE COUPLER**  
**MANCHON FILETAGE MÂLE**

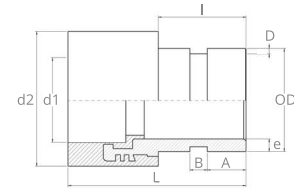

code	∅ (mm)	dimensión Vitaulic	d1 (mm)	d2 (pulg / in)	OD (mm)	A (mm)	B (mm)	D (mm)	e (mm)	L (mm)	I (mm)				€/U
854R54040	40	DN32 1-1/4"	40	65	42,4	15,88	7,14	1,60	5,1	83	36	2	12	5.365	43,159
854R55050	50	DN40 1-1/2"	50	68	48,3	15,88	7,14	1,60	4,7	88	36	2	10	5.830	53,754
854R56363	63	DN50 2"	63	83,5	60,3	15,88	8,74	1,60	4,4	100	40	1	6	5.465	66,297
854R57575	75	DN50 2-1/2"	75	98	73,0	15,88	8,74	1,98	5,1	104	40,5	1	3	4.800	99,613
854R59090	90	DN80 3"	90	119	88,9	15,88	8,74	1,98	4,2	130	50	1	2	6.505	170,205

**ENLACE RECTO TUERCA LOCA H.**  
**LOOSE NUT STRAIGHT ADAPTOR**  
**RACCORD DROIT ÉCROU FOU**

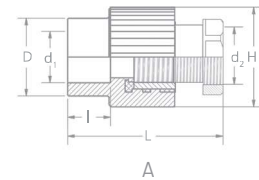

code	type	∅ (mm)	d1 (mm)	d2 (pulg / in)	D (mm)	H (mm)	I (mm)	L (mm)				€/U
827R32525	A	25 x 3/4"	25	3/4"	34,5	40,0	16	55,5	10	60	9.128	12,891
827R32532	A	25 x 1"	25	1"	34,5	44,5	16	57,0	10	40	7.000	18,959

**ENLACE RECTO TUERCA LOCA H.**  
**LOOSE NUT STRAIGHT ADAPTOR**  
**RACCORD DROIT ÉCROU FOU**

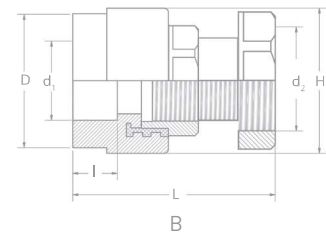

code	type	∅ (mm)	d1 (mm)	d2 (pulg / in)	D (mm)	H (mm)	I (mm)	L (mm)				€/U
827R33232	B	32 x 1"	32	1"	46,0	51,0	18,0	64	5	30	6.000	22,199
827R33240	B	32 x 1-1/4"	32	1-1/4"	47,5	60,5	18,0	84	5	20	8.500	37,147
827R34040	B	40 x 1-1/4"	40	1-1/4"	65,0	71,0	20,5	75	5	15	7.000	44,078

**CONECTOR UNIVERSAL**  
**UNIVERSAL ADAPTOR**  
**RACCORD UNIVEREL EN LAITON**

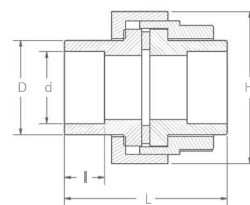
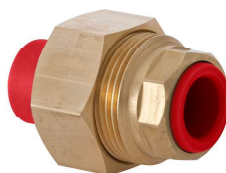

code	∅ (mm)	d (mm)	D (mm)	H (mm)	I (mm)	L (mm)			€/U
846R00032	32	32	41,5	68	18,0	69,5	20	8.000	51,392
846R00040	40	40	53,0	86	20,5	73,5	12	9.500	85,977
846R00050	50	50	58,0	96	23,5	78,0	8	6.400	107,163
846R00063	63	63	73,0	116	27,5	87,0	5	9.412	167,621
846R00075	75	75	88,0	138	30,0	94,0	4	8.500	231,240
846R00090	90	90	109,0	175	33,0	101,0	2	7.548	428,666
846R00110	110	110	130,0	202	37,0	108,0	2	8.340	530,536

**CONECTOR ROSCA HEMBRA**  
**THREADED FEMALE ADAPTOR**  
**RACCORD FILETAGE FEMELLE**

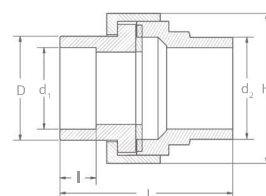

code	∅ (mm)	d1 (mm)	d2 (pulg / in)	D (mm)	H (mm)	I (mm)	L (mm)			€/U
8471R0025	25 x 3/4"	25	3/4"	36	48	16	60	30	8.350	34,733
8471R0032	32 x 1"	32	1"	41,5	54	18	65	20	8.500	51,248
8471R0040	40 x 1-1/4"	40	1-1/4"	53	67	20,5	71	12	8.000	84,064
8471R0050	50 x 1-1/2"	50	1-1/2"	58	76	23,5	85,5	8	7.000	121,905
8471R0063	63 x 2"	63	2"	73	92,5	27,5	96	6	9.330	178,705
8471R0075	75 x 2-1/2"	75	2-1/2"	88	90	30	138	4	9.500	286,441

**CONECTOR ROSCA MACHO**  
**THREADED MALE ADAPTOR**  
**RACCORD FILETAGE MÂLE**

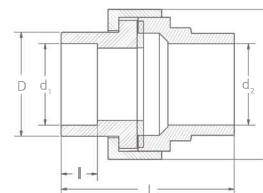
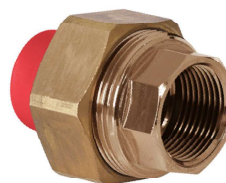

code	∅ (mm)	d1 (mm)	d2 (pulg / in)	D (mm)	H (mm)	I (mm)	L (mm)			€/U
8472R0025	25 x 3/4"	25	3/4"	36,0	54	16,0	58,0	30	8.950	34,733
8472R0032	32 x 1"	32	1"	41,5	68	18,0	57,5	20	8.000	51,248
8472R0050	50 x 1-1/2"	50	1-1/2"	58,0	96	23,5	71,0	8	7.450	121,905
8472R0063	63 x 2"	63	2"	73	116	27,5	75,07	6	8.790	177,315
8472R0075	75 x 2-1/2"	75	2-1/2"	88,0	138	30,0	79,0	4	9.000	220,621

**CUELLO BRIDA CON JUNTA**  
**STUB FLANGE WITH GASKET**  
**SUPPORT DE BRIDE AVEC JOINT**

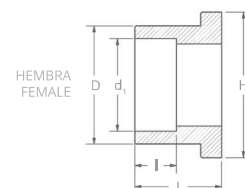

	code	Ø (mm)	d1 (mm)	D (mm)	H (mm)	L (mm)	I1 (mm)				€/U
SOLDADURA SOCKET	8491R0032	32	32	40,5	50,0	33,0	18,0	10	70	2.325	4,797
	8491R0040	40	40	49,5	60,0	35,5	20,5	6	42	2.050	6,792
	8491R0050	50	50	59,0	71,5	37,5	23,5	4	24	1.790	10,788
	8491R0063	63	63	76	101	41	27,4	2	16	2.400	12,952
	8491R0075	75	75	89,1	121,9	45,9	30,4	2	12	2.830	15,114
	8491R0090	90	90	109,0	137,0	49,5	33,0	1	7	2.145	23,751
	8491R0110	110	110	130,0	156,0	52,5	37,0	1	5	2.005	32,379
	8491R0125	125	125	163,0	186,5	65,0	40,0	1	2	7.799	59,804

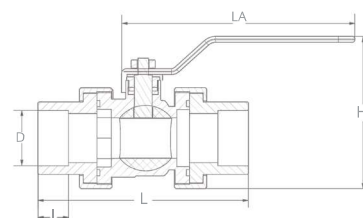

**LLAVE BOLA DESMONTABLE  
 CON CUELLO BRIDA**  
**BRASS BALL STOPCOCK VALVE**  
**VANNE À BOISSEAU**

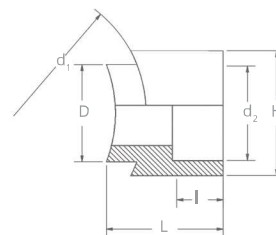

code	Ø (mm)	D (mm)	H (mm)	I (mm)	L (mm)	LA (mm)			€/U
83642R025	25	25	78,5	16,0	111,5	103,0	25	11.500	31,304
83642R032	32	32	89,5	18,0	120,0	121,0	15	11.000	45,391
83642R040	40	40	106,0	20,5	138,0	151,5	8	9.320	76,431
83642R050	50	50	125,5	23,5	148,5	162,0	6	11.000	125,060
83642R063	63	63	150,5	27,5	164,0	165,5	3	9.000	196,998

**DERIVACIÓN SALIDA HEMBRA**  
**FEMALE SADDLE ADAPTOR**  
**RACCORD CAVALIER FEMELLE**



code	∅ (mm)	d1 (mm)	d2 (mm)	D (mm)	H (mm)	I (mm)	L (mm)				€/U
840R04025	40 - 25	40	25	20-25	38,0	16,0	41,5	5	75	1.735	3,279
840R05025	50 - 25	50	25	20-25	38,0	16,0	37,5	5	75	1.685	3,235
840R06325	63 - 25	63	25	20-25	38,5	16,0	38,0	5	75	1.695	3,235
840R07525	75 - 25	75	25	20-25	37,5	16,0	40,0	5	75	1.745	3,235
840R09025	90 - 25	90	25	20-25	38,0	16,0	40,5	5	60	1.496	3,235
840R11025	110 - 25	110	25	20-25	39,0	16,0	41,0	5	45	1.134	3,235
840R12525	125 - 25	125	25	20-25	37,5	16,0	44,0	5	50	1.307	3,235
840R16025	160 - 25	160	25	20-25	38,0	16,0	47,0	5	70	1.812	3,235
840R06332	63 - 32	63	32	32	42,5	18,0	42,5	5	75	2.380	4,324
840R07532	75 - 32	75	32	32	42,5	18,0	41,5	5	60	1.920	4,324
840R09032	90 - 32	90	32	32	42,5	18,0	43,0	5	45	1.520	4,324
840R11032	110 - 32	110	32	32	42,5	18,0	44,0	5	45	1.520	4,324
840R12532	125 - 32	125	32	32	42,5	18,0	48,0	5	45	1.595	4,324
840R16032	160 - 32	160	32	32	42,5	18,0	50,0	5	70	2.573	4,324
840R07540	75 - 40	75	40	40	51,5	20,5	47,0	5	50	2.980	5,695
840R09040	90 - 40	90	40	40	51,5	20,5	46,5	5	35	1.870	5,695
840R11040	110 - 40	110	40	40	51,5	20,5	48,0	5	35	2.006	5,695
840R12540	125 - 40	125	40	40	51,5	20,5	52,5	5	40	2.389	5,695
840R16040	160 - 40	160	40	40	51,5	20,5	54,0	5	40	2.426	5,695
840R11050	110 - 50	110	50	50	68,0	23,5	51,5	5	25	2.385	6,424
840R12550	125 - 50	125	50	50	67,5	23,5	53,0	3	27	2.625	6,424
840R16050	160 - 50	160	50	50	68,0	23,5	54,5	5	20	2.142	6,424
840R11063	110 - 63	110	63	63	83,5	27,5	60,0	6	12	1.920	10,895
840R12563	125 - 63	125	63	63	82,0	27,5	60,5	3	15	2.395	10,895
840R16063	160 - 63	160	63	63	82,0	27,5	61,0	4	16	2.727	10,895

**DERIVACIÓN SALIDA MACHO**  
**MALE SADDLE ADAPTOR**  
**RACCORD CAVALIER MÂLE**

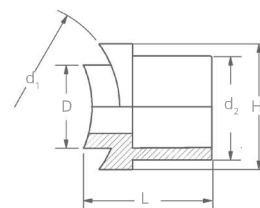

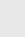

code	∅ (mm)	d1 (mm)	d2 (mm)	D (taladro) (mm)	H (mm)	L (mm)			€/U
841R11063	110 - 63	110	63	50,0	67,0	87,0	12	1.630	20,188
841R12563	125 - 63	125	63	50,0	67,0	80,0	12	1.440	19,694
841R16063	160 - 63	160	63	50,0	67,0	82,0	12	1.630	19,694
841R11075	110 - 75	110	75	63,0	82,0	95,0	12	2.350	24,152
841R12575	125 - 75	125	75	63,0	82,0	90,0	12	2.230	23,562
841R16075	160 - 75	160	75	63,0	82,0	95,0	12	2.230	23,562
841R12590	125 - 90	125	90	75,0	101,5	111,5	6	2.700	28,549
841R16090	160 - 90	160	90	75,0	101,0	103,5	6	1.800	28,549
841R16011	160 - 110	160	110	87,0	120,0	113,0	3	1.580	50,514

(1) En la matriz soldasientos, seleccione el diámetro (D) inmediatamente inferior al diámetro (d2) de la derivación.  
 (1) In the saddle dies, select the diameter (D) immediately smaller than the diameter (d2) of the saddle adaptor.  
 (1) Dans la matrice de derivation, sélectionner le diamètre (D) immédiatement inférieur au diamètre (d2) du raccord cavalier

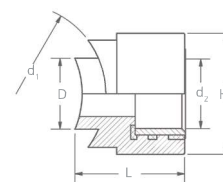

**DERIVACIÓN ROSCA HEMBRA**  
**THREADED FEMALE SADDLE ADAPTOR**  
**RACCORD CAVALIER FILETAGE FEMELLE**

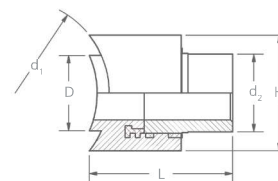
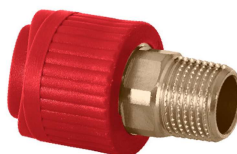

code	Ø (mm)	d1 (mm)	d2 (pulg / in)	D (mm)	H (mm)	L (mm)				€/U
8451R4012	40 x 1/2"	40	1/2"	20 - 25	37,5	42,0	5	75	4.150	8,195
8451R5012	50 x 1/2"	50	1/2"	20 - 25	38,0	37,5	5	75	4.130	8,195
8451R6312	63 x 1/2"	63	1/2"	20 - 25	38,0	39,0	5	75	4.145	8,195
8451R7512	75 x 1/2"	75	1/2"	20 - 25	38,5	39,5	5	75	4.210	8,195
8451R9012	90 x 1/2"	90	1/2"	20 - 25	38,0	40,5	5	75	4.727	8,195
8451R1012	110 x 1/2"	110	1/2"	20 - 25	38,0	42,0	5	75	4.759	8,195
8451R2512	125 x 1/2"	125	1/2"	20 - 25	38,0	43,5	5	70	4.100	8,195
8451R6012	160 x 1/2"	160	1/2"	20 - 25	38,0	47,5	5	70	4.637	8,195
8451R4034	40 x 3/4"	40	3/4"	20 - 25	43,0	41,5	5	75	5.520	10,480
8451R5034	50 x 3/4"	50	3/4"	20 - 25	42,5	37,5	5	65	4.770	10,480
8451R6334	63 x 3/4"	63	3/4"	20 - 25	43,0	38,5	5	65	4.550	10,480
8451R7534	75 x 3/4"	75	3/4"	20 - 25	43,0	40,0	5	65	5.411	10,480
8451R9034	90 x 3/4"	90	3/4"	20 - 25	43,0	40,5	5	70	5.100	10,480
8451R1034	110 x 3/4"	110	3/4"	20 - 25	43,0	41,5	5	70	5.275	10,480
8451R2534	125 x 3/4"	125	3/4"	20 - 25	43,0	43,5	5	70	5.750	10,480
8451R6034	160 x 3/4"	160	3/4"	20 - 25	42,5	47,0	5	70	5.965	10,480
8451R7532	75 x 1"	75	1"	40	57,0	51,0	5	40	9.466	20,617
8451R9032	90 x 1"	90	1"	40	57,0	52,0	5	35	7.838	20,617
8451R1032	110 x 1"	110	1"	40	57,0	52,0	5	35	9.238	20,617
8451R2532	125 x 1"	125	1"	40	57,0	56,0	5	35	8.608	20,617
8451R6032	160 x 1"	160	1"	40	57,0	57,5	5	30	7.450	20,617

**DERIVACIÓN ROSCA MACHO**  
**THREADED MALE SADDLE ADAPTOR**  
**RACCORD CAVALIER FILETAGE MÂLE**



code	Ø (mm)	d1 (mm)	d2 (pulg/in)	D (taladro) (mm)	H (mm)	L (mm)				€/U
8452R6312	63 x 1/2"	63	1/2"	20 - 25	36,00	59,50	5	75	9.504	13,390
8452R7512	75 x 1/2"	75	1/2"	20 - 25	36,00	59,50	5	75	9.461	13,390
8452R9012	90 x 1/2"	90	1/2"	20 - 25	36,00	59,50	5	75	9.643	13,390
8452R6334	63 x 3/4"	63	3/4"	20 - 25	39,00	59,50	5	75	12.220	15,954
8452R7534	75 x 3/4"	75	3/4"	20 - 25	39,00	59,50	5	75	12.220	17,008
8452R9034	90 x 3/4"	90	3/4"	20 - 25	39,00	59,50	5	75	12.428	17,008

**TAPÓN DE REPARACIÓN**  
**REPAIR CAP**  
**BOUCHON DE RÉPARATION**

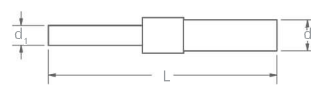

code	∅ (mm)	d1 (mm)	d2 (mm)	L (mm)				€/U
843R00711	7 x 11	7	11	83	100	400	2.500	1,346

**CODO 90° SEGMENTADO TOPE**  
**90° SEGMENTED BUTT WELD ELBOW**  
**COUDE SEGMENTÉ À 90° BOUT À BOUT**

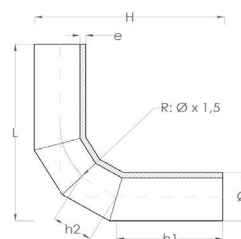

code	∅ (mm)	R (mm)	e (mm)	h1 (mm)	h2 (mm)	L=H (mm)				€/U
1822R00161	160	240	14,6	215	127	470	1	1	1.884	(1)

(1) Bajo demanda. Consultar precio y disponibilidad. / (1) On request. Check availability and price. / (1) Sur demande vérifier le prix et la disponibilité

(2) Todas las referencias son SDR 11(2) / All references are SDR 11 / (2) Toutes les références sont SDR 11

**CODO 45° SEGMENTADO TOPE**  
**45° SEGMENTED BUTT WELD ELBOW**  
**COUDE SEGMENTÉ À 45° BOUT À BOUT**

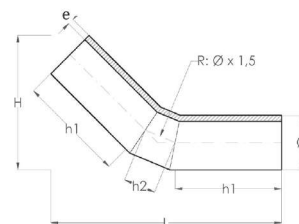

code	∅ (mm)	R (mm)	e (mm)	h1 (mm)	h2 (mm)	L (mm)	H (mm)				€/U
823R00161	160	240	14,6	198	95	483	313	1	1	2.076	(1)

(1) Bajo demanda. Consultar precio y disponibilidad. / (1) On request. Check availability and price. / (1) Sur demande vérifier le prix et la disponibilité

(2) Todas las referencias son SDR 11(2) / All references are SDR 11 / (2) Toutes les références sont SDR 11

**TE TOPE LARGA SEGMENTADA**  
**LONG BUTT WELD SEGMENTED TEE**  
**TÉ LONGUE BOUT À BOUT SEGMENTÉ**

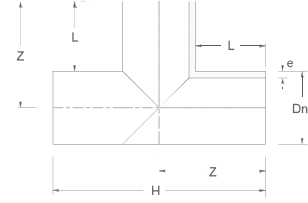

code	∅ (mm)	R (mm)	e (mm)	h1 (mm)	h2 (mm)	L (mm)	H (mm)				€/U
824R00161	160	141	160	14,6	240	160	480	1	1	3.259	(1)

(1) Bajo demanda. Consultar precio y disponibilidad. / (1) On request. Check availability and price. / (1) Sur demande vérifier le prix et la disponibilité

**TE REDUCIDA DERIVACIÓN MACHO**  
**BUTT WELD REDUCER TEE**  
**TÉ DE RÉDUCTION BOUT À BOUT**

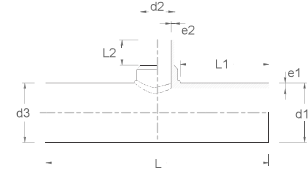

code	∅ (mm)	d1 (mm)	e1 (mm)	d2 (mm)	e2 (mm)	L (mm)	Z (mm)	h (mm)				€/U
825R75125	125 x 75 x 125	125	11,4	75	6,8	580	209	75	1	1	2.196	(1)
825R90125	125 x 90 x 125			90	8,2				2.750	(1)		
825R90160	160 x 90 x 160	160	14,6	90	8,2	580	209	75	1	1	3.811	(1)
825R11160	160 x 110 x 160			110	10,0				3.900	(1)		

(1) Bajo demanda. Consultar precio y disponibilidad. / (1) On request. Check availability and price. / (1) Sur demande vérifier le prix et la disponibilité

**CUELLO BRIDA TOPE LARGO**  
**LONG STUB FLANGE**  
**SUPPORT DE BRIDE LONGUE BOUT À BOUT**

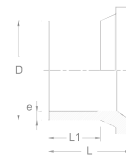

code <sup>1</sup>	∅ (mm)	D (mm)	e (mm)	L (mm)	L1 (mm)				€/U
8491R0160	160	160	14,5	180,1	104,6	1	12	16.620	109,413

(2) Ninguno incluye junta / (2) Gasket not included in any reference / (2) Aucun n'inclut de joint  
 (3) El ángulo del chafalán en todas las referencias es ≈60° / (3) The chamfer angle in all references is ≈60° / (3) L'angle du chanfrein sur toutes les références est ≈60°  
 (4) Presión de trabajo SDR11 / (4) Working pressure SDR11 / (4) Pression de service SDR11